

# SPECIFICATION



**DOORS**  
Attractive main entrance door with standard fittings  
Decorative doors for all other rooms and toilets  
French doors for terrace



**ELECTRIFICATION**  
Adequate light points with concealed copper wiring along with modular switches  
Switch of standard make  
Power point for fridge, washing machine & water purifier



**PAINTING**  
Oil bond paint in all rooms  
Acrylic paint on external walls



**WINDOWS**  
Powder coated aluminium sliding windows  
Safety grill for all windows  
Green marble frame for all windows



**CONVENIENCE**  
Provision for cable connection in living room  
Name plate for each flat



**STRUCTURE**  
Earthquake resistant R.C.C. frame structure.  
6" Brickwork for Internal Walls & 6" for external Walls  
Sand Face Plaster for External Walls & smooth Finish Plaster for Internal Walls.



**KITCHEN**  
Granite Kitchen Platform with Stainless Steel Sink.  
Decorative digital print tile dado on the Kitchen wall  
Provision for exhaust fan  
Dry terrace with provision for washing machine (inlet & outlet)  
Provision for water purifier system



**FLOORING**  
2'X2' vitrified tiles for flooring in living, kitchen & all bedroom  
Mat finished tiles in balcony & wash area  
Anti skid tiles in bathrooms



**TOILETS & BATHROOM**  
Coloured glazed tiles dado in all bathrooms  
WC glazed tiles dado up to 3' height  
Concealed Plumbing and Branded fitting with hot & cold mixture  
Orissa pan in WC and in common toilets of 2 RHK



## LOCATION MAP



Brand Communication  
Design Core / 770908074

A project by:



**Site Address:**  
Gat No. 930, Near PCMC Pumping Station, Newale Wasti, Chikhali, Pune: 412114  
Web: [www.newerapune.com](http://www.newerapune.com)

**Call: 83908 91644, 8007770004**

**RCC Consultant:**  
M/S G.A. Bhilare & Associates Pune  
**Adviser:**  
Adv. Ashok R Wagh, Chinchwad  
**Architect:**  
M/S Khire Bhide Associate, Pune

This brochure is not legal offering. The developers reserve absolute rights to change / cancel any plans, layouts, no. of floors and / or specifications at their discretion. Images are for representational purposes only



**NEW ERA**  
2 BHK SPACIOUS FLATS

@ CHIKHALI



# 2 BHK



- A Living Room
- B Bedroom
- C Kitchen
- D Terrace
- E Bathroom
- F Toilet



# 1 BHK

- A Living Room
- B Bedroom
- C Kitchen
- D Terrace
- E Bathroom
- F Toilet

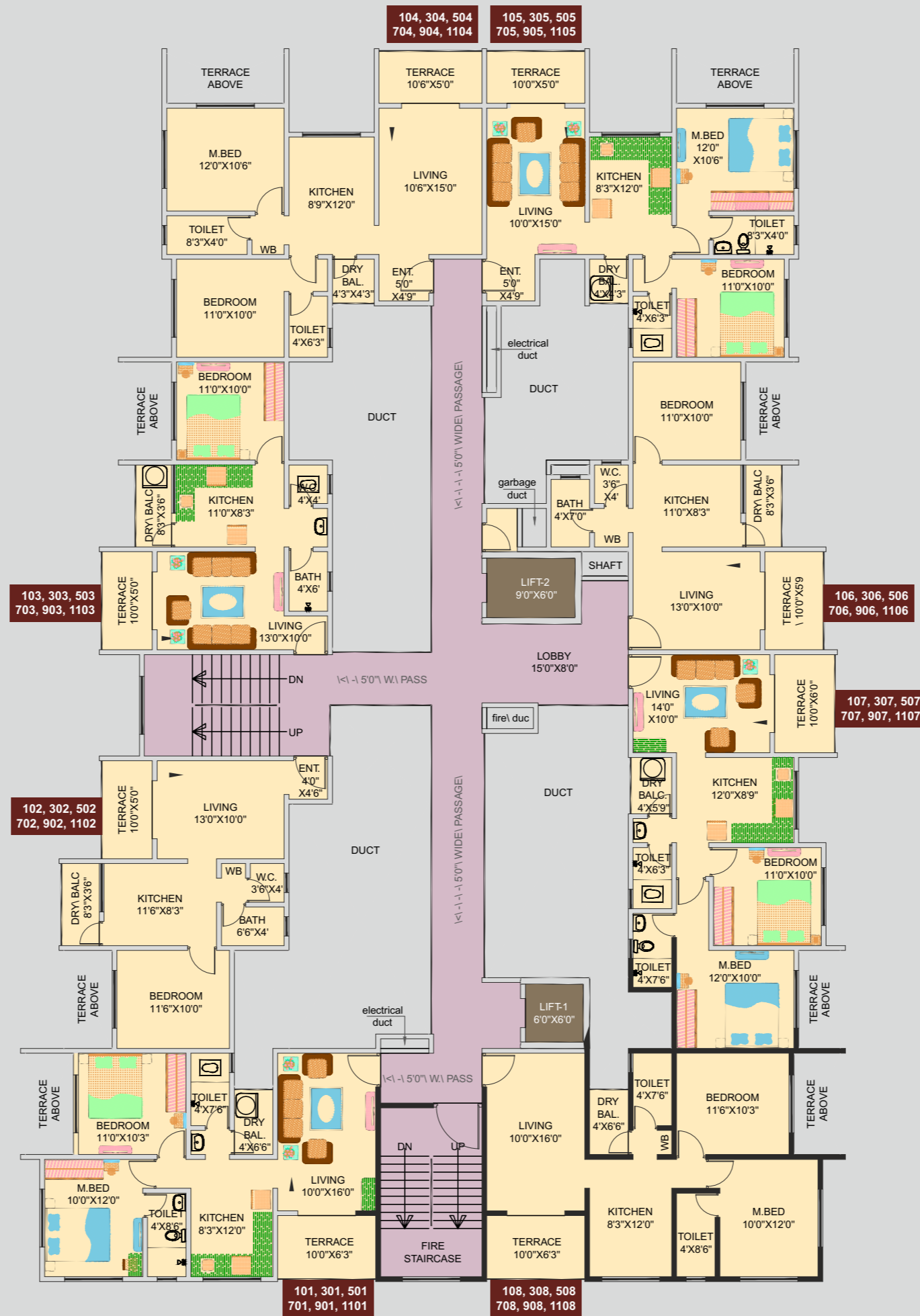

TYPICAL 1ST, 3RD, 5TH, 7TH, 9TH & 11TH FLOOR PLAN

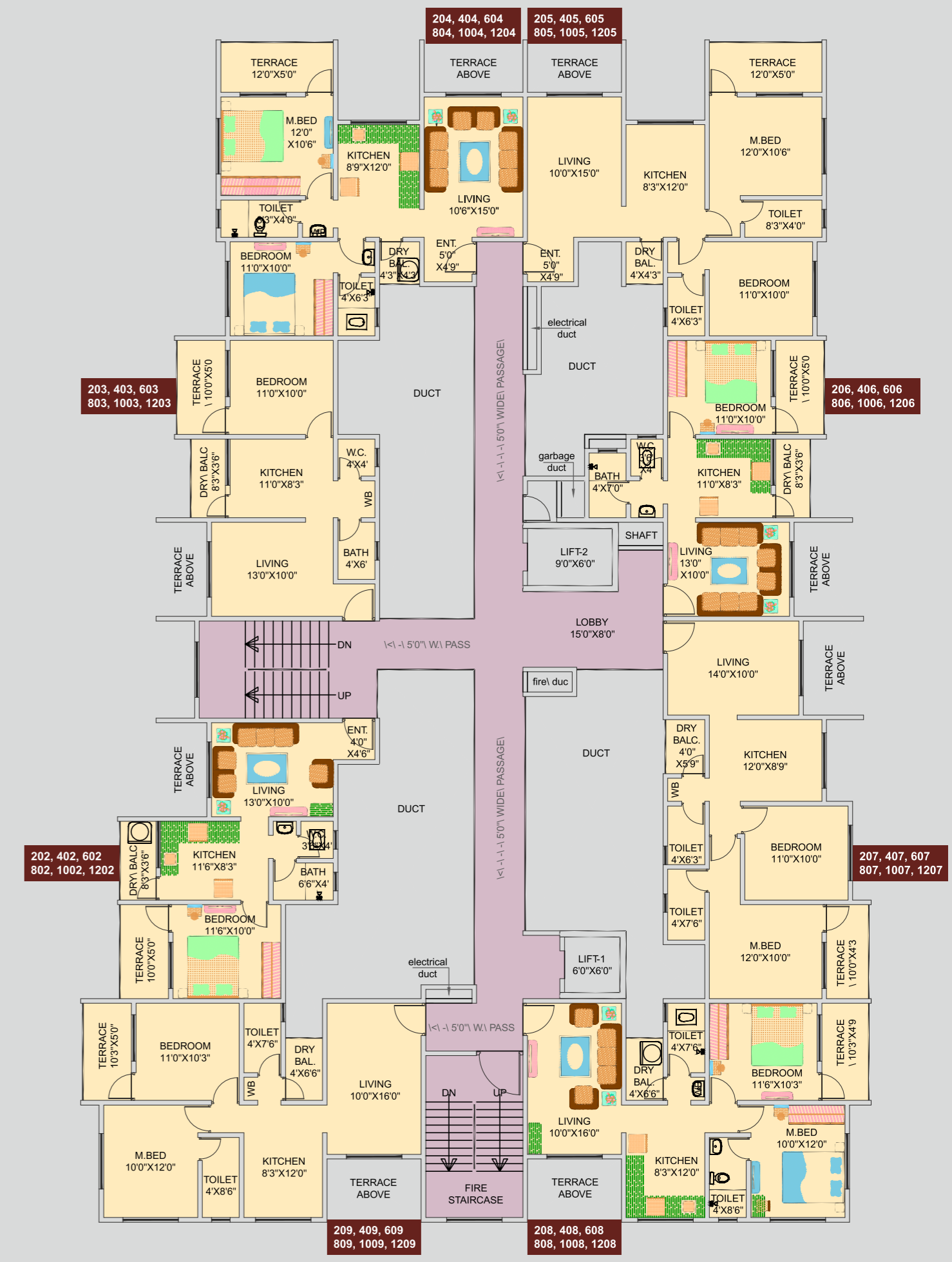

TYPICAL 2ND, 4TH, 6TH, 8TH, 10TH & 12TH FLOOR PLAN

